



# Sitka Rocky Gutierrez Airport Terminal Improvements

## About the Project

The Sitka Airport Terminal Improvements Project corrects a number of existing critical airport terminal deficiencies. The project includes building additions as well as remodeling most parts of the existing terminal building. Construction of improvements will be phased due to funding and the need for the terminal to continue operations throughout the project.

The project consists of two main phases, (1) The Expansion Phase, and (2) The Remodel and Curb-Side Improvements Phase.

The Expansion Phase includes construction of a 2-story addition on the SE side of the terminal to house new passenger screening and passenger gate lounges with an up escalator, an elevator, restrooms, and a concessions area. This phase also includes the demolition of the existing Bag-Make-up and Passenger Ramp to be replaced with a two-story addition housing an enlarged bag makeup room with a passenger boarding bridge above and a ramp connecting deplaning passengers to the bag claim area.

The Remodel and Curb-Side Improvements Phase involves interior remodel of the existing terminal to improve passenger flow, TSA baggage screening and expand the baggage claim belt and area. This phase also includes small additions on the curb side of the terminal with new entrances/exits for arrivals and departures and a new curb-side canopy along the length of the building. New interior finishes and building systems will tie the remodeled building into the additions.



**Project Rendering - Remodel Phase 2**

## Schedule

*(note these dates are subject to change)*

### Phase 1A - February 2024 - January 2025

Expect minimal impact to Terminal operations until August. Fenced construction work next to the existing building. Late summer will see a transition to ground boarding.

### Phase 1B - January 2025 - May 2025

Expect ground boarding and deplaning of aircraft as the jetway ramp is replaced and the additions finished.

### Phase 2 - June 2025 - Summer 2026

The new addition will be open and the existing building will be under renovation with different areas closed periodically. Expect significant changes to passenger and baggage flow.

**If you have questions or want to learn more, visit our website or contact:**

Melissa Wileman  
Public & Government Relations Director  
melissa.wileman@cityofsitka.org

Joseph Bea  
Airport Terminal Manager  
joseph.bea@cityofsitka.org



Scan me!

<https://exploresitkaairportdesign.net/>



# Sitka Rocky Gutierrez Airport Terminal Improvements

## Frequently Asked Questions

### Why do we need to make improvements to the Sitka Airport Terminal?

The Sitka Airport building is very outdated. The building is too small for the current levels of passengers and operations and has no room to grow. The passenger gate lounge is cramped and lacks services. Additionally, the baggage claim is too small, and the main door serves both arriving and departing passengers causing congestion and confusion.

### What improvements are planned for the Sitka Airport Terminal?

Phase 1 of the project is the 'Expansion Phase'. The work during Phase 1 will include the construction of a new, 2-story addition on the SE side of the terminal which will include new passenger screening (2 lanes), new passenger gate lounges (5x bigger), new restrooms, and a new concessions area. This phase also includes a new jetway to the passenger boarding bridge.

Phase 2 of the project is the "Remodel and Curb-Side Phase". The work will include a remodel of the existing building that will include TSA baggage screening, a larger (3x) baggage claim and new entrances and exits for arrivals and departure to relieve congestion. Finally, there will be a new canopy along the entire front of the building.

This project will double the size of the terminal from 18,000 to 36,000sf.

### How will this impact me during construction?

Phase 1A (February 2024 – January 2025): Initially, there will be very little impact on the traveling public. You will see the building expansion phase being constructed, but there will be little impact to the existing terminal until August. In late summer the passenger loading ramp will be demolished and passenger boarding and deplaning will be from the ground via mobile stairs or ramps.

Phase 1B (January 2025 - May 2025): Expect ground boarding and deplaning of aircraft as the jetway ramp is replaced.

Phase 2 (June 2025 - Project Completion in Summer 2026): Impacts to travelers will be more significant including temporary circulation detours for TSA passenger screening, passenger pick-up and drop-off changes. All passengers and those visiting the airport will need to plan ahead by giving yourself extra time to clear security. All airport visitors should pay very close attention to construction and detour signs for direction.

### What will happen to the Nugget Restaurant and the Gift Shop?

The gift shop area and the Nugget Restaurant will remain where they are. However there will be brief closures and changes to open hours of these amenities during both phases of construction. New finishes will be installed in these areas to the extent allowed by the grant funding.

### Who is paying for this?

The overall project is going to cost \$40 million dollars. About \$36 million dollars are coming from TSA and FAA Grant funds, both federal funding sources. The remaining \$4 million is a required local match. In 2019 Sitka issued about \$4 million in revenue bonds paid for by the Passenger Facility Charge – on airfares to and from Sitka.

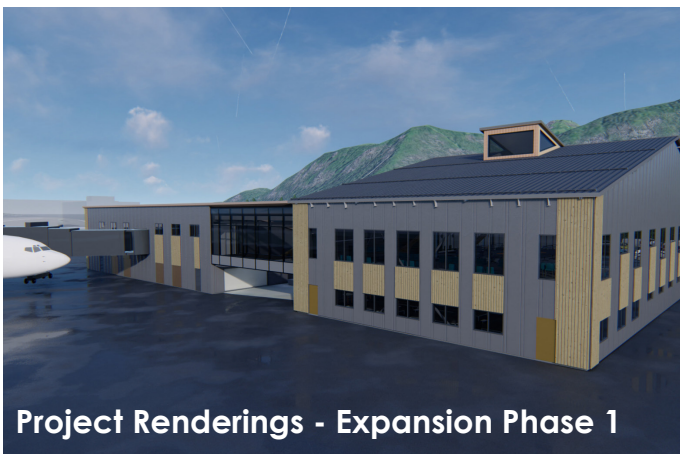

Project Renderings - Expansion Phase 1